

REV	DESCRIPTION	DESIGN	DATE
A0	NEW RELEASE	Wudanping	2016/05/05
A1	Increase the gold-plating specification	Wudanping	2017/03/03
A2	The correct current	Jiangjianyin	2019/03/29

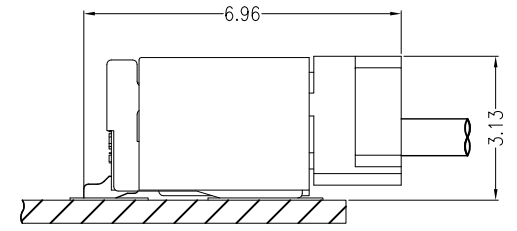

Assembly Layout

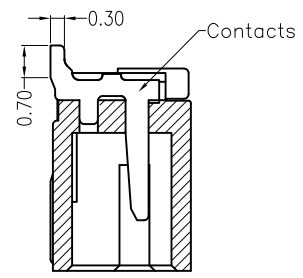
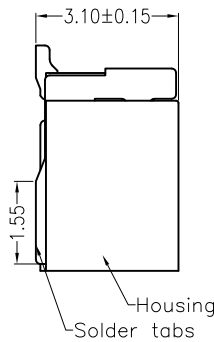
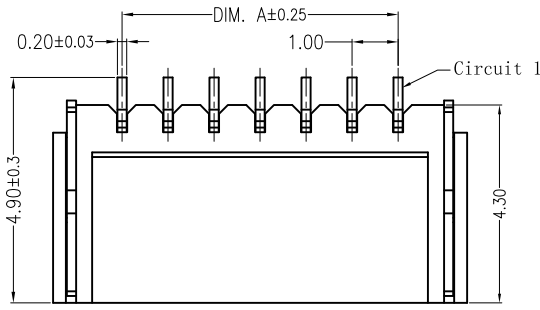
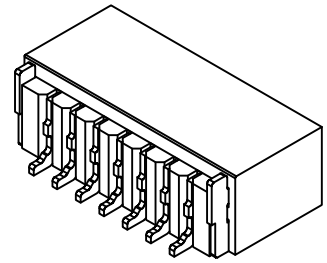
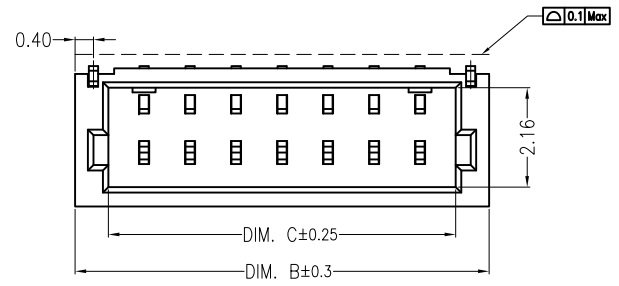

**Specifications:**

- Contact resistance:  $\leq 20\text{m}\Omega$
- Insulation resistance:  $\geq 100\text{M}\Omega$
- Rated voltage: 50V AC DC
- Rated current: 1.0A AC DC  $\square$
- Withstand voltage: 500V AC/minute
- Temperature range:  $-25^{\circ}\text{C} \sim +105^{\circ}\text{C}$
- Housing: LCP UL94V-0 (Natural/Black)
- Contacts: Phosphor bronze (Matte sn/Gold plating)
- Solder tabs: Phosphor bronze/Matte sn

**ORDER INFORMATION:**

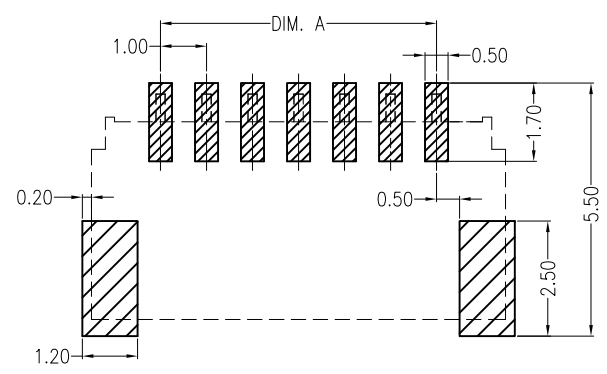
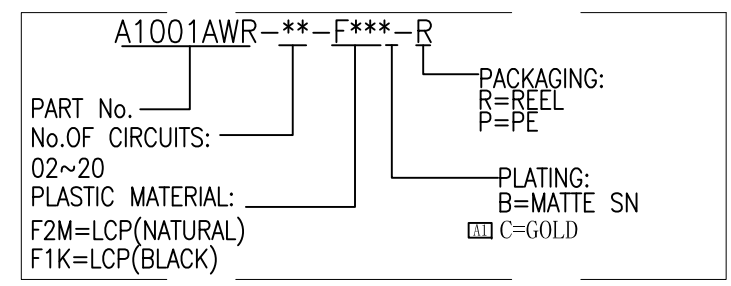

Recommend PCB Layout

Circuit	Dimensions (mm)		
	DIM. A	DIM. B	DIM. C
02	1.00	4.00	2.45
03	2.00	5.00	3.45
04	3.00	6.00	4.45
05	4.00	7.00	5.45
06	5.00	8.00	6.45
07	6.00	9.00	7.45
08	7.00	10.00	8.45
09	8.00	11.00	9.45
10	9.00	12.00	10.45
11	10.00	13.00	11.45
12	11.00	14.00	12.45
13	12.00	15.00	13.45
14	13.00	16.00	14.45
15	14.00	17.00	15.45
16	15.00	18.00	16.45
20	19.00	22.00	20.45

<b>JKUN</b> 温州健坤接插件有限公司 WENZHOU JKUN CONNECTOR CO.,LTD.		TITLE: 1.0mmPITCH 90°WAFER SMT TYPE	
		PART NO.: A1001AWR-**-F***-R	
GENERAL TOLERANCE X. $\pm 0.50$ X. $\pm 5^{\circ}$ X.X $\pm 0.30$ X.X $\pm 2^{\circ}$ X.XX $\pm 0.20$ X.XX $\pm 1^{\circ}$		USE: CUSTOMER APPD: Shaojinghe CHKD: Zlinglingqing	DWG NO.: JKUN/GCKH-0501
UNITS: mm		DR: Jiangjianyin	SCALE 1 : 1      SHEET 1 / 1